



International Harvester Collectors • Chapter #23

# ALABAMA

## Fall 2016

### TRACTOR SHOW

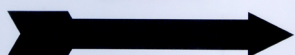

The 2016 Alabama IH State Show was hosted by the annual Piney Chapel show near Athens in north Alabama. International Harvester was the feature brand of the show, so the Piney Chapel organizers reserved a separate display field for Red machinery as well as our chapter tent.



Frank Brown (#564) (left) and Sherman Roberts (#2) at the Georgia Chapter #29 State Show at Inman, GA in September. Frank, whose home chapter is #29, proudly displayed a banner featuring the 2018 Red Power Round Up logo as a way to promote the big show that's coming to Montgomery.



Darwin Prewitt (#485) (left) at the Texas Chapter #25 State Show at Temple, TX. He stayed busy promoting Red Power Round Up 2018 to Chapter #25 members and visitors but stopped long enough to make this picture with Tina (#540) and Don McGuffin (#539). Don is also president of Texas Chapter #25.

# Randy's Ramblings

• President's Letter from Randy Bodine •

This year has really flown by. It's hard to believe that we are only a few months away from the start of 2017! We have had some very good shows this year. Our state show at Piney Chapel was a lot of fun and very successful. Thanks to the Piney Chapel Antique Engine & Tractor Association for being such wonderful hosts.

Our next and final chapter meeting of the year will be at Greenville Old Time Farm Days. Greenville is just south of Montgomery (see map on page 6). Member Cary Thompson will be sure we get to see syrup making, plowing, combining peanuts, running a saw mill, as well as a slow race and tractor parade. There will also be arts and crafts, so there is something for everyone to enjoy. During our chapter meeting at 11:00 am we will be adding three new directors, setting the dates for our chapter meetings for next year, and finalizing the show schedule for 2017.

Be sure to take note of the flyer on page 9 of this newsletter about our bus trip to Red Power Round Up in Des Moines, Iowa. Because of deadlines set by the hotels in Des Moines, we have an earlier date to reserve your spot. This is the last RPRU before we host in 2018, so we need as many members as possible to attend. This will be our opportunity to sign up vendors, exhibitors, and provide information. We want to represent our chapter well so that everyone will be excited about coming to Alabama. I want to thank all of you who attended RPRU 2016 in Union Grove, Wisconsin. We had a large turnout of our Alabama Chapter #23 members and so many people from other states commented to me about how impressed they were that our members were so active. Let's have even more members join us in Des Moines for RPRU 2017.

After our chapter meeting in Greenville, we will move to Garrett Coliseum to continue to make plans for RPRU 2018. This will give everyone an opportunity to visit the venue and see the grounds being used for the Alabama National Fair. We will meet in Harvester Hall for the RPRU 2018 committee meeting probably around 3:00 pm on Saturday, October 29. I hope many of you are planning to

take exhibits to display in Harvester Hall during the fair (see flyer on page 7). Last year was a great success and it gives us a wonderful opportunity to promote RPRU 2018.

By now, you will have received your 2017 membership renewal notice. I want to encourage you to send in your dues check as soon as possible. Also, I want to challenge each member to set a goal of enrolling at least one new member. More specifically, I would like for you to take a look at the membership map for the state of Alabama on page 4. It is filling in nicely with members all over the state. However, some counties do not have any members. Let's try to get at least one member in each county. If you know someone in a county that does not have any members, then invite them to join. Once the seed has been planted, it will grow and produce more fruit. Also, when you renew your membership, make sure we have your email address. We have more and more information that we need to get to our members between newsletters. As RPRU 2018 draws closer, we would love to communicate with you through email to keep you updated.

If you have not been involved with Chapter #23, I am asking you to get involved. Volunteer for a position. I plan to get everyone on a committee, so if you have a particular area that you would be interested in serving in, please be sure to let me know. We are a very diverse group. We see each other at shows and we all have a common interest in antique equipment. However, our club is made up of people from hundreds of different walks of life. We have teachers, bankers, business owners, homemakers, pilots ... and the list goes on. Many of you have certain talents that you use in your daily lives that I may not be aware of, so please let me know your special skills. We can certainly find a way to put those skills and talents to use – especially with Red Power Round Up coming up in 2018!

I'm looking forward to seeing you all at Greenville!

Happy Tractoring!

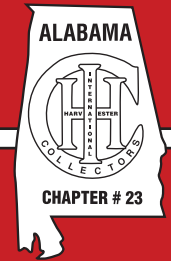

## Officers

### Randy L. Bodine – President

1798 Lauren Lane  
Auburn, AL 36830-7562  
(334) 887-8867  
randy@bodines.com

### Gary Bell – Vice President

58 N. Johnson Chapel Rd.  
Danville, AL 35619-6504  
(256) 773-4922  
(256) 303-9525  
gbell4922@charter.net

### Clay Nordan – Sec./Treas.

2907 Virginia Road  
Birmingham, AL 35223-1253  
(205) 870-1535  
cnordan@me.com

## Directors

### Joe Criswell '16

P.O. Box 538  
Snead, AL 35952-0538  
(205) 466-3500  
sneadequip@yahoo.com

### Clay Nordan '16

**Donnie Wedgworth '16**  
782 AL Highway 61  
Greensboro, AL 36744-5490  
(334) 352-1038  
donniwedgworth@gmail.com

### Charles Allen '17

4518 Mitzi Dr.  
Gardendale, AL 35071-2664  
(205) 631-4173  
cwallen3@att.net

### Wiley Johnson '17

156 Jimshill Rd.  
Wetumpka, AL 36093-2421  
(334) 514-6395  
tractormanjhn@aol.com

### Conrad Bell '17

701 Cherokee Ln. NW  
Hartselle, AL 35640-1721  
(256) 773-2614  
cbell701@charter.net

### Buck Brown '18

347 State Farm Road  
Alexandria, AL 36250-6028  
(256) 452-1793  
bbrown@tractor-equipment.com

### Charlie Grimmitt '18

808 W. 6th St.  
Sheffield, AL 35660-2532  
(256) 381-7268  
pilottlitecharlie@yahoo.com

### Dean Higgins '18

357 Hoagtown Loop  
Sylvan Springs, AL 35118-9709  
(205) 491-6062

## Advisors

Gary Bell  
Brad Bodine  
Larry Lemmond

An Alabama 501 (c)(7)  
Non-Profit Corporation



**Minutes of AL Chapter #23  
International Harvester Collectors  
Meeting at Piney Chapel  
11:00 a.m., August 6, 2016**

6 Directors present

Charles Allen  
Conrad Bell  
Buck Brown  
Charlie Grimmitt  
Clay Nordan  
Donnie Wedgworth

2 Advisors present

Gary Bell  
Larry Lemmond

23 Members present

Larry Allen  
Sharon Allen  
Buddy Banks  
Jake Beams  
Jana Bodine  
Kasey Bodine  
Randy Bodine  
Robert Bodine  
Jerry Briley  
Skeet Cooper  
Roger Heath

8 Visitors present

Hope Banks  
Robin Blue  
Roselea Cooper  
Tammy Crofoot  
Sally Grimmitt  
Justin Grimmitt  
Dianne Manning  
Wayne Whitt

Hal Hoaglin  
Dennis Johnson  
Franklin Jones  
Ronnie Lott  
Hybart Majors  
Keith Manning  
Grady Morrow  
Carl Pletcher  
Jane Roberts  
Sherman Roberts  
Glenn Sanders  
Tenia Smith

The meeting was called to order by president Randy Bodine and he began the meeting with an invocation.

The first agenda item was Clay's report. He had no additions to the minutes as published in the recent newsletter and said that the chapter balance is currently \$17,480.17. He also reported that membership currently stands at 279 and that some new members were expected to join today.

Clay also reported that dues collection will start a month earlier this year than in the past due to the fact that the national membership secretary has notified us that our dues payment for 2017 is payable on November 1, 2016. Dues notices will go into the mail around October 1, so members need to take advantage of the self-addressed-stamped envelope that will be provided and get their checks into the mail as soon as possible. Randy reiterated that dues collection should not take months and asked that all members send in their checks just as soon as they get the notice.

Randy called for a motion to accept the minutes and Clay's report. There was a motion, second, and the motion was approved.

The first item on the agenda was a reminder that all expenditures related to the 2018 Red Power Round Up must be pre-approved by the show chairman (Randy), the vice-chairman (Gary Bell), or the financial chair (Jana Bodine).

Next, Randy stated that the logo for

the 2018 RPRU has been finalized and that a nice example was printed in the recent newsletter for everyone to see.

The next agenda item was a reminder that we are still looking for a member to head up the RPRU Merchandising Committee. Randy asked that any members who feel qualified to take on this important position please step forward and let it be known that they are interested in this important leadership role.

Next on the agenda, Randy encouraged any members present to offer any thoughts or observations about what they saw and learned at this year's RPRU in Wisconsin. There was some good discussion about what worked and what did not work. And Randy used Clay's recent written report on his experience with show book photography at Union Grove as an example of how committee chairmen can communicate preparation and progress in their respective areas of responsibility.

Randy encouraged all committees to keep thinking about what needs to be done to make our show the success we are hoping for, and he asked that any ideas be sent to him via email. He said that we have a running list that we started several years ago of ideas for RPRU 2018 and we need to build on those ideas to have a successful show.

Next on the agenda was a lively discussion about options for RPRU parades. Nothing was resolved, but all issues and concerns related to parades were put on the table for later consideration.

The next agenda item was a reminder about the Winter Convention scheduled for March 2-4, 2017 at Columbus, IN. Randy encouraged everyone to attend this important event and be willing to work the chapter table, hand out information, and sign-up vendors.

In conjunction with this announcement, Randy then transitioned to the 2017 Red Power Round Up to be held at Des Moines, Iowa, June 14-17, 2017. He made it clear that this will be our most important event other than the 2018 RPRU itself. Everyone there will be making plans for the next RPRU and that will be 2018. He said that we will need ALL HANDS ON DECK in Iowa next summer.

The next agenda item was a request that if a member knows of anyone who might be willing to help sponsor RPRU 2018 to let Randy know. This is an important facet of putting on the show and we need to get these sponsors lined up as soon as we can.

The next item was a reminder that

our final meeting of the year will be at the Greenville Show on October 29. Greenville is on I-65 about an hour south of Montgomery in Butler County. This will be the first time we have met at this show, so everyone is encouraged to come enjoy this new tractor show venue.

Also, following the meeting at Greenville, we will adjourn to Montgomery and the grounds of Garrett Coliseum for a Red Power Round Up meeting. The Alabama National Fair will be underway at that time, so we will get an ideal demonstration of how the Garrett facility measures up for a big event that should attract a large number of visitors over a weekend.

Randy asked that if any members can't make it to Greenville, they should try to join us for the meeting at Garrett that afternoon. He said that this will be a very important meeting as we tour the grounds and finalize some logistical plans. This is especially important for members who have never been to the show grounds.

He also mentioned that he intends to schedule a Red Power Roundup meeting for some time in the winter (Dec/Jan). The location will probably be somewhere in north Alabama and the date and time will be announced later.

The final items on the agenda included an announcement that RPRU show toy negotiations are still underway, and that the feature tractor for 2018 will be "Offset" tractors (Cub, Cub Lo-Boy, A, Super A, B, 100, 130, 140 and IH 274). Also, the website, [www.rpru2018.com](http://www.rpru2018.com) and the FaceBook page should be up and running soon.

Randy encouraged everyone to stick around and come back to the tent for our designated Red Power Round Up meeting at 1:00 pm today.

The meeting came to a close with Randy going around the circle and recognizing anyone with a show to plug. The shows promoted by members were: Jeans on the River, Orrville, Hartselle Depot Days, St. Florian, East Alabama (Wedowee), Southland Flywheelers, and Fyffe UFO Days.

With no further business to discuss, the meeting was adjourned.

*Respectfully submitted,  
Clay Nordan – Secretary/Treasurer*

 **Attention** 

**Chapter #23 Members**

**If You Haven't Paid Already, Now is the Time to Send in Your 2017 Dues Renewal!**

**Don't Delay**



**Do it Today**

Jeans on the River restaurant near Cordova in Walker County.



**280 Active Members**

### Out of State Members

Florida .....	4	Mississippi .....	3
Georgia .....	12	Nebraska .....	1
Indiana .....	2	Tennessee .....	3
Louisiana .....	7	Texas .....	2



We were saddened to learn of the passing of Alan Eisenberg (#476) of Montevallo this past August. Alan joined Chapter #23 in 2013 and enjoyed bringing his restored Cub to tractor shows around the state. Alan had significant health problems in recent years and was a double amputee caused by his diabetes. With the help of his good friend, Buck Phillips (#422) he installed a special lift to the back of his Cub for the power scooter that got him around at tractor shows.

### Financial Report

**Net Assets, August 2016 .....\$18,725.78**

#### Income

**Cap & T-shirt sales .....27.00**

**Dues Collected .....100.00**

**Subtotal ..... 127.00**

#### Expenses

**Newsletter .....968.33**

**Dues Collection Postage .....287.28**

**National Dues Paid ..... 60.00**

**Subtotal ..... 1315.61**

**Net Assets, October 2016 .....\$17,537.17**

(Final State and National Dues Collection numbers will be reported in the Early Spring 2017 newsletter.)

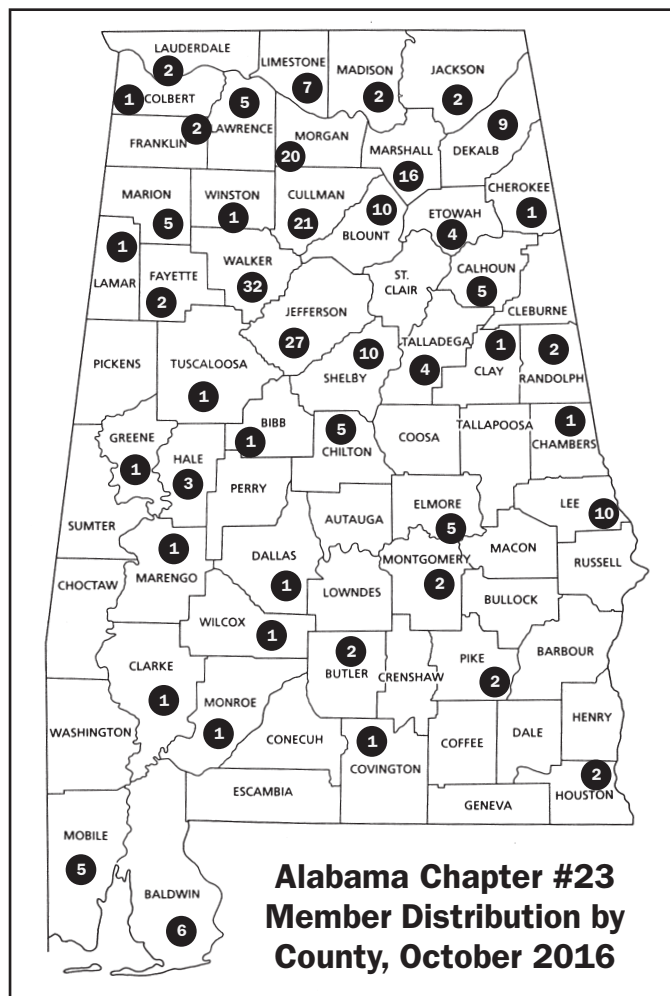

Buy • Sell • Trade  
Collect • Tractors & Parts  
Literature & Books



**Roy's  
Red Iron**

6929 Martha Ave.  
East Ridge, TN 37412  
www.roysrediron.com

**Roy & Donna Edwards**  
(423) 892-5289  
Cell: (423) 290-5036

Chapter #23 Member #131 – Joined the Club in 2001

### 2016 Tractor Show Schedule

Hartselle – Southland Flywheelers Farm ..... Oct. 22  
Lake Park, GA – Alapahoochee ..... Oct. 22  
Montgomery – AL State Fair ..... Oct. 28-Nov. 6  
\*\*Greenville ..... Oct. 29  
Jasper Veterans Day ..... Nov. 5  
Orrville ..... Nov. 12

\*\*Alabama Chapter 23 Meeting at 11:00 a.m.





# TALLADEGA TRACTOR COMPANY

Kubota  STIHL®

**RONNIE LOTT, President**  
205-365-1629 • rlott@talladegainternational.com

*What Else Can We Do For YOU?*

256-362-6113 • 800-593-6113 • Fax: 256-362-6551  
35450 AL Hwy 21 N • Talladega, AL 35160  
www.talladegainternational.com



**BUSH HOG**



## MOULTON IMPLEMENT CO., INC.

13511 ALABAMA Hwy. 157

P.O. Box 548

MOULTON, ALABAMA 35650

KENT GILLEY

256-974-5021

## Paquette's Historical Farmall Museum J Stewart Paquette

Restorer



Collector

www.stewsihstuff.com

stewsstuff@gmail.com

Cell 352-267-4448 Phone 352-728-3588

## Alabama Tractor Pickers



**BUY/SELL TOP CASH \$\$\$ PAID  
IH FARMALL TRACTORS**

• Specializing in Cub, Super A, 100, 130, & 140 "offset" tractors & in Cultivating and Planting Equipment, as well as many other implements and parts.



**Larry Gamble**  
205-529-5999

**Chase Gamble**  
205-368-5339

ihfarmallrtr@gmail.com

**Next Directors Meeting • Greenville Alabama Show  
October 29, 2016 • 11:00 a.m.**

**Red Power Round Up Meeting to follow in the  
afternoon at Garrett Coliseum in Montgomery**

# B&R

## TRACTOR & EQUIPMENT

ALL Your Logging Supplies • Tires & Oil Products  
+ ALL YOUR BIG TRUCK PARTS

**RAYFORD JOHNSON**

HWY. 9 N.

LINEVILLE, AL 36266

256-396-0343

## Devon's Tractor Parts

888-560-1466

1910 E. 202nd Street, Westfield, IN 46074

Fax: (317) 867-3892 Email: dwil317@yahoo.com

www.devonstractorparts.com



## SNEAD EQUIPMENT SALES & SERVICE, INC.

88043 Hwy 278 East

P.O. Box 538

Snead, AL 35952

Ph: 205-466-3500

205-466-7168

Fax: 205-466-7169

www.sneadequip.com

Joe Criswell

**Vermeer**

**MCCORMICK**

**NEW IDEA**



**R**estoring

**O**ld

**C**lassics

**Ronnie  
Carroll**  
943-8585  
Cell: 942-2120





Robert Bodine (#170) went to his cotton field early on Sept. 24 to pull some growing cotton plants to use in his display of a Farmall Super H and cotton duster attachment at Eva. The plants were used to show how the duster distributes powdered insecticide.



A nice turnout of red tractors on display at the big show at Eva in September.



The big American flag tent always provides shade and cover for visitors at Eva.

### Map to Greenville, Alabama

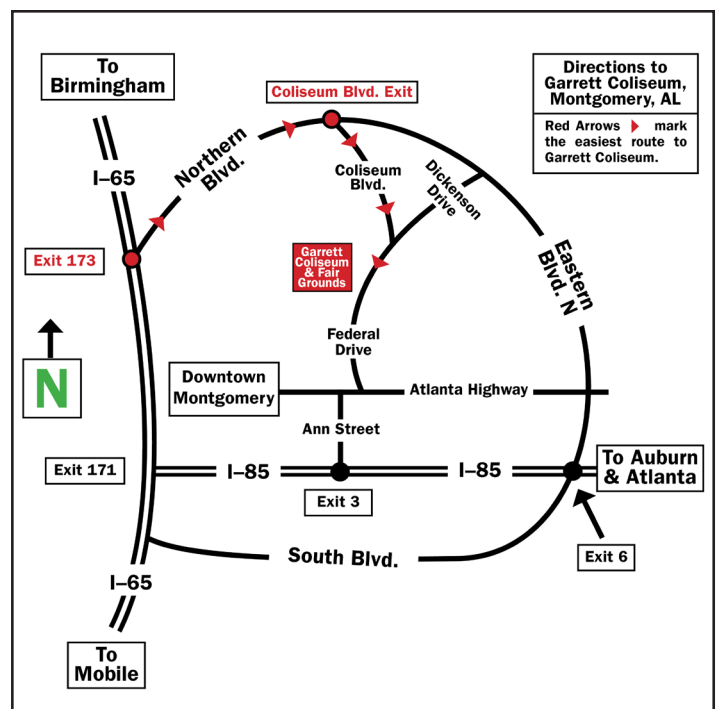
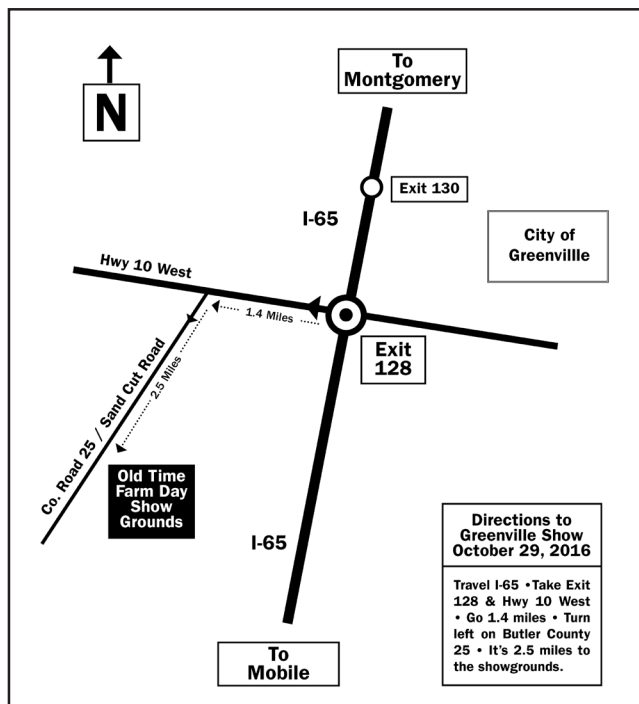

### Map to Garrett Coliseum – Montgomery, Alabama



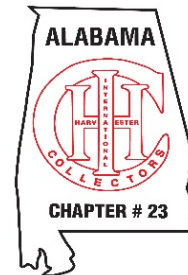

**LET'S BRING AGRICULTURE  
HERITAGE  
BACK TO THE  
STATE FAIR!**

**October 28<sup>th</sup> – November 6<sup>th</sup> 2016  
Garrett Coliseum, Montgomery, AL**

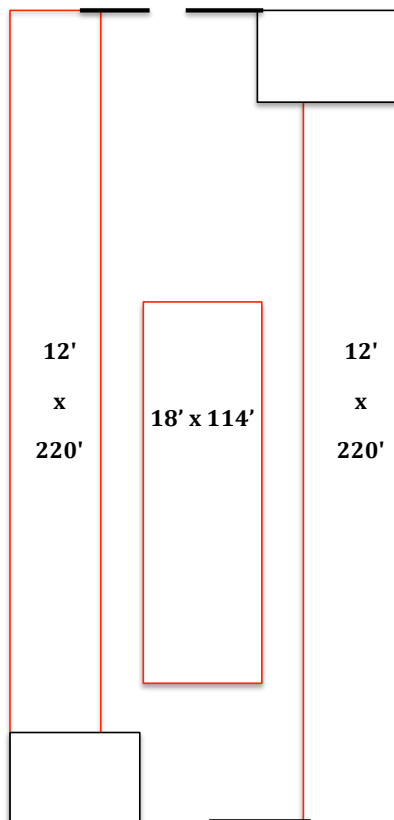

The Alabama National Fair is inviting **ALL** tractors, implements and demonstrations that reflect our agriculture heritage. All makes and models are welcome. The exhibits will be housed inside a 220' x 80', concrete floor building, able to hold at least 100 tractors. If your display is mounted on a trailer, there is plenty of room to drop the trailer inside the building. **Exhibits can be set up from October 19<sup>th</sup>-26<sup>th</sup>.** Exhibits remain on display throughout the fair. You do not have to stay with your exhibit unless you want to. **The exhibits can be removed from November 7<sup>th</sup>-14<sup>th</sup>.**

**For More Information Contact:**  
**Randy Bodine, President of Alabama IHC #23 – (334) 749-4958**  
**Stephanie Pittman, Alabama National Fair – (334) 272-6831**  
**1555 Federal Drive, Montgomery, AL**



# Carl's Cut-Away 2N Ford

The Ford 9N, 2N, and 8N series of tractors, based on the innovative three-point hitch implement connection system invented by Harry Ferguson has been popular with Alabama farmers since its introduction in 1939. Carl Pletcher (#471) of Altoona in Etowah County displayed his recently completed "cut-away" model 2N at the show at Snead in April and got lots of compliments for the clear, easy to understand methods he employed to show the inner workings of the famous machine.

Carl came up with a clever scheme of color coding that identifies the various mechanisms and systems that are essential to the operation of

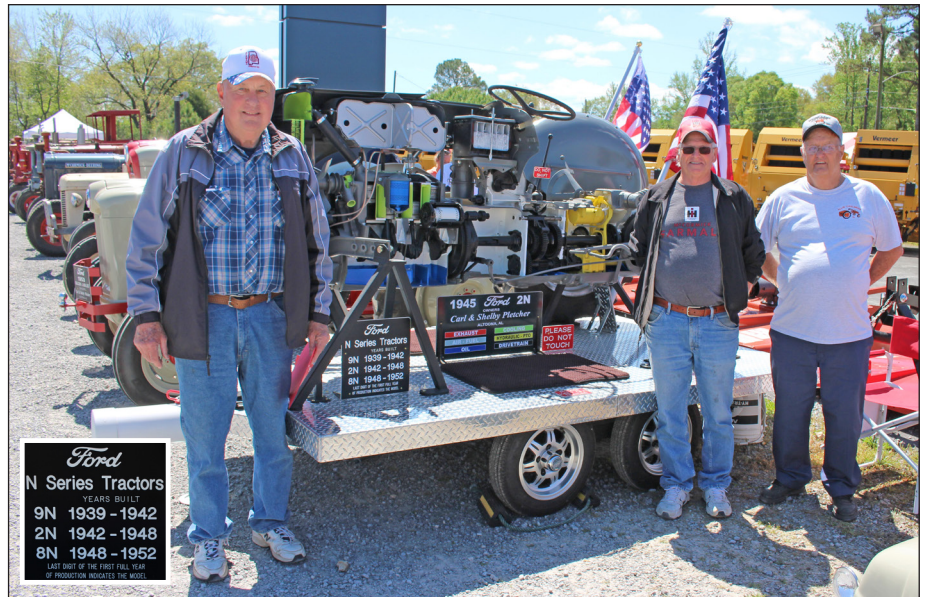

Carl Pletcher (left), with Mike Gallahar (#434) of Munford & Larcus Mayo (#495) of Talladega. Mike & Larcus helped Carl get the 2N finished in time for the 2016 season.

the tractor. It sits on a good looking custom built trailer that Carl can move around a show grounds with a four-wheel drive golf cart. A sign

with the tractor explains that each number associated with the 9N, 2N, & 8N is a designation for the first year that model was built.



Chapter #23 members at the Eagleville, TN show in Early September. (Left to right) Sherman Roberts, Jane Roberts, Robert Bodine, Logan Bodine, Conrad Bell, Gary Bell, Keith Manning, Dianne Manning, Harold Beck, Retha Beck.



***TENTATIVE ITINERARY  
FOR CHARTER BUS TOUR  
2017 RED POWER ROUND UP  
Des Moines, Iowa  
June 12 – 18, 2017***



**REGISTER  
TODAY!**

June 12, 2017 – Depart from Madison, Alabama  
Stay overnight in Williamsburg, Iowa

June 13, 2017 – Tour headquarters of Kinze Innovation Center/Plant,  
Home of the Kinze planter, located in Williamsburg,  
Iowa

Tour the personal collection and working farm of Jon  
Kinzenbaw. See hundreds of tractors stacked on shelves  
three-stories high, like toys displayed on a shelf

June 14, 2017 – Arrive at Red Power Round Up, Des Moines, Iowa

June 15, 2017 – Red Power Round Up, Des Moines, Iowa  
Additional tours will be available on your own. See website  
[www.catchdesmoines.com/rpru2017](http://www.catchdesmoines.com/rpru2017) for more information.

June 16, 2017 – Red Power Round Up, Des Moines, Iowa

June 17, 2017 – Depart Des Moines, Iowa  
Stay overnight south of Des Moines, Iowa

June 18, 2017 – Arrive in Madison, Alabama

**DEADLINE: IF YOU WANT TO GO ON THE BUS, WE MUST KNOW BY MARCH 10, 2017.  
IN ORDER TO HOLD A SPOT ON THE BUS AND GUARANTEE A HOTEL ROOM, WE NEED A NON-  
REFUNDABLE DEPOSIT OF \$100. DUE TO RESERVATION DEADLINES GIVEN BY THE HOTEL, THESE  
ROOMS WILL NO LONGER BE AVAILABLE FOR THIS BUS TRIP AFTER MARCH 10.**

**COST - \$625\*\* per person – Double Occupancy.**

\*Price includes bus travel round trip from Madison, Alabama, to Des Moines, Iowa, tours, 6 night's hotel stay, and includes transportation to and from Red Power Round Up each day. Does not include admission for Red Power Round Up. Balance for trip is due before departure.

\*\*Price subject to change based on total number on trip. Only fifty seats on the bus. Act now – it's filling up fast.

Make checks payable to: **Alabama Chapter #23 Tours.** Send to: Randy Bodine, 1798 Lauren Lane  
Auburn, AL 36830.

For more information, contact Randy Bodine at (334) 749-4958 or email [randy@bodines.com](mailto:randy@bodines.com).





**Billy Ferguson (#47) can always be counted on to have an impressive display of Farmall restorations at the Piney Chapel show, which is located very close to his home.**

**(Right) Two immaculate displays of restored early Farmall tractors at Piney Chapel. Pictured on the left is a 1938 F-20 owned by John & Kim Brown of Greenbrier, TN. On the right is an F-12 owned by Don Scott of White House, TN.**



**(Below left) Donnie Wedgworth (#444) on his Farmall 504 with his grandson in the parade at Piney Chapel.**

**(Below right) Robert Bodine (#170) on a Farmall Super H with grandson Logan Bodine in the parade at Piney Chapel in August.**







This year's Jeans on the River show featured a cool sunny day and a good turnout of mostly red tractors and some nice vintage car restorations. Quite a few Chapter #23 members came to the show to support the efforts of Glenn Sanders (#15), Ray Best (#97), and Becky Johnson (#341). (Bottom photo) Sherman Roberts publicizes the 2018 Red Power Round Up using his IH B-130 truck.





International Harvester Collectors  
Chapter #23  
2907 Virginia Road  
Birmingham, AL 35223

PRSR STD  
U.S. POSTAGE  
PAID  
BIRMINGHAM, AL  
PERMIT #85



## THE AWARDS PALACE

*Awards fit for a King or Queen*

425 2nd Avenue SW  
Cullman, Alabama 35055

256-737-8787

256-737-8796 FAX

**Randy Sparks**

[awardspalace@gmail.com](mailto:awardspalace@gmail.com)

[www.awardspalace.com](http://www.awardspalace.com)

*Royal Treatment For Every Customer*



We Buy & Sell Used  
Farm Equipment



## CAMPBELL'S USED PARTS TRACTORS & IMPLEMENTS

4351 Pulaski Highway  
Lawrenceburg, TN 38464

JAMES W. CAMPBELL

(931) 762-7185

(931) 242-5211

## Little Red Tractor Co. LLC

Parts for Old IH Tractors & Equipment  
Manuals for Most Brands

**Glen Mlnarik**  
(402) 986-1352

124 Marion Street  
Howells, NE 68641

e-mail: [glen@littleredtractor.net](mailto:glen@littleredtractor.net)  
[www.littleredtractorco.com](http://www.littleredtractorco.com)

Hours: Monday-Thursday 8-5

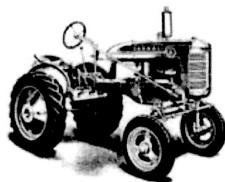

## Jean's On The River Restaurant

Open Thursday thru Sunday  
11:00 AM to 8:30 PM

Phone:  
(205) 483-0024

Phone:  
(205) 648-7171